

AMERICAN MOTORS PARTS CATALOG

GROUP 22 WINDSHIELD WIPER - COWL VENT - INST. PANEL

DESCRIPTION	GROUP AND FIGURE NO.	GROUP NO.
ARM, Windshield Wiper	22-1, 0-14, 0-15	22.044
BLADE, Windshield Wiper	22-1, Refer Group 0	22.043
BODY, Windshield Wiper Pivot Shaft	22-1	22.047
BOX, Glove	0-15	22.058
BUMPER, Glove Box	22.072
CABLE, Cowl Ventilator Control	0-15	22.018
CASE, Glove Box Lock Cylinder	22-2	22.073
CONTROL, Windshield Wiper	22-1	22.038
COVER, Instrument Panel Ash Receiver	0-14	22.093
COVER, Windshield Wiper Motor Access Hole	22.120
CYLINDER, Glove Box Lock	22-2	22.073
DAMPER, Cowl Ventilator	22.023
DOOR, Glove Box	0-14	22.060
GRILLE, Radio Speaker	22.077
HOSE, Windshield Wiper	4-4	22.050
KEY, Glove Box Lock Cylinder	22-2	22.073
KNOB, Windshield Wiper Control	22-1, 0-14, 0-15	22.039
LINK, Glove Box Door Check	22.066
LOCK, Glove Box	22-2, 0-14, 0-15	22.073
MOTOR, Windshield Wiper	22-1	22.027
MOULDING, Instrument Panel Overlay	0-14, 0-15	22.100
NUT, Windshield Wiper Control Holding	22.041
OVERLAY, Instrument Panel	0-14	22.100
PAD, Instrument Panel Overlay	22.100
PANEL, Ash Receiver and Instrument Switch Mounting	0-15	22.098
PANEL, Cowl Ventilator Intake Cover	Refer Group 0	22.016
PANEL, Instrument	0-14, 0-15	22.056
PANEL, Instrument Panel	0-15	22.100
PLATE, Instrument Panel Name	0-15	22.103
RETAINER, Instrument Panel Ash Receiver	22.096
RETAINER, Windshield Wiper Linkage	22-1	22.030
ROD, Cowl Ventilator Hinge	22.014
SCREEN, Cowl Ventilator	22.007
SPACER, Windshield Wiper Pivot Shaft Body	22-1	22.047
STRIKER, Glove Box Lock	22.075
TRAY, Instrument Ash Receiver	0-15	22.092
TUBE, Windshield Wiper	4-3, 4-4, 4-5	22.050

AMERICAN MOTORS PARTS CATALOG

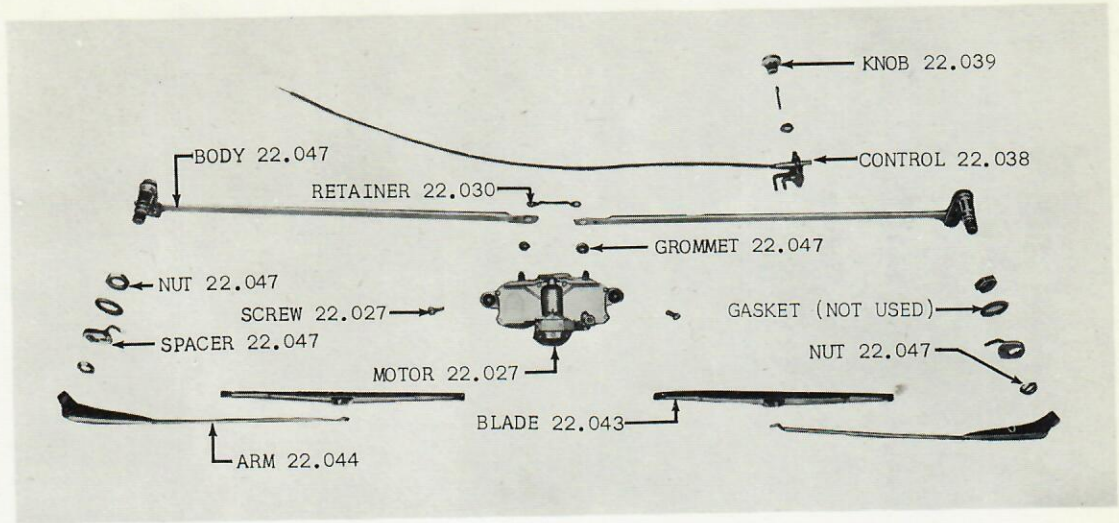

GROUP 22 - FIG. 1 - WINDSHIELD WIPER ASSEMBLY 01-10-20-80

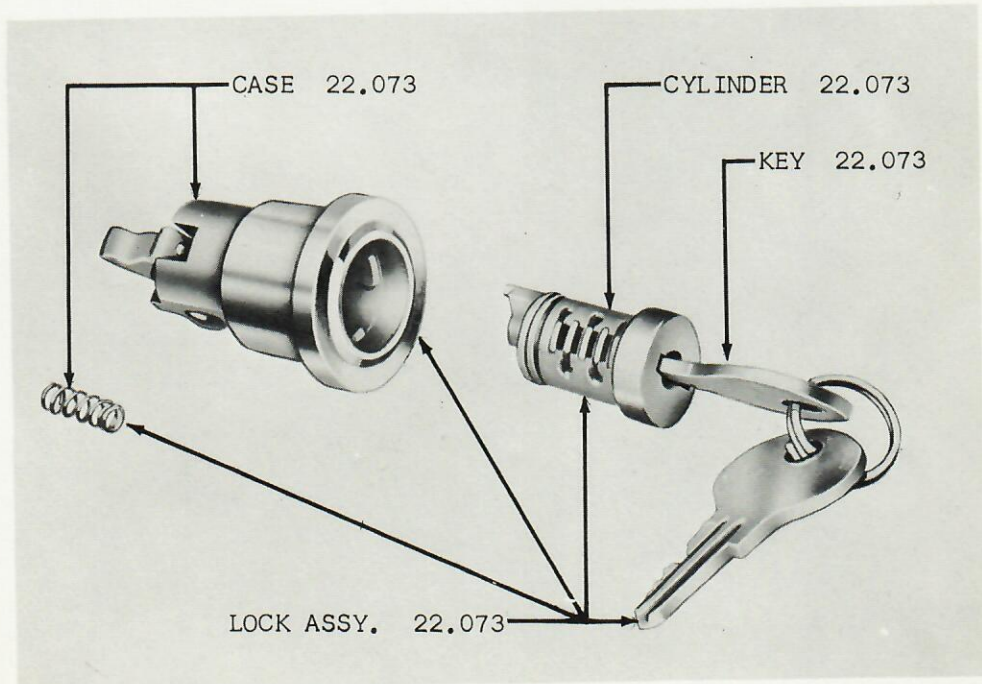

GROUP 22 - FIG. 2 - GLOVE BOX LOCK 01

AMERICAN MOTORS PARTS CATALOG

22.018

DESCRIPTION	YEAR AND MODEL	PER CAR	PART NO.
GROUP 22 WINDSHIELD WIPER - COWL VENT - INST. PANEL			
22.007 SCREEN, Cowl Ventilator			
SCREEN.....	59 01.....	1	343 0429
(Left).....	59 10-20-80.....	1	342 9761
(Right).....	59 10-20-80.....	1	342 9762
SCREW.....	59 01.....	8	800 0272
	59 10-20-80.....	6	341 6750
22.014 ROD, Cowl Ventilator Hinge			
ROD.....	59 01.....	1	313 0263
	59 10-20-80.....	1	314 6516
PLATE, Support (Left).....	59 01.....	1	433 2016
(Right).....	59 01.....	1	433 2017
GASKET, Plate.....	59 01.....	2	433 2018
GROMMET.....	59 10-20-80.....	2	314 3158
BUSHING.....	59 01.....	2	313 0265
PIN, Retainer.....	59 10-20-80.....	1	G103361
SCREW, Plate.....	59 01.....	4	G180016
To Damper.....	59 01.....	2	G174964
	59 10-20-80.....	2	G161901
WASHER.....	59 01.....	2	G131096
	59 10-20-80.....	2	G120392
Plate.....	59 01.....	4	G120423
Bushing.....	59 01.....	2	313 0317
22.016 PANEL, Cowl Ventilator Intake Cover			
PANEL.....	59 01.....	1	437 3230
	59 10-20-80.....	1	341 1100
GROMMET.....	59 01.....	1	436 7429
SCREW.....	59 01.....	2	G162246
22.018 CABLE - CONTROL, Cowl Ventilator			
CABLE (Inner)(Incl. Knob).....	59 01.....	1	311 6306
(Only).....	59 10-20-80 (LHD).....	1	320 0919
	59 10-80 (RHD).....	1	320 0923
ARMOR.....	59 01.....	1	311 4022
CONTROL (Less Cables).....	59 10-20-80.....	1	320 0920
(With Cables)(Less Heater).....	59 10-20-80 (LHD).....	1	342 2239
	59 10-80 (RHD).....	1	342 8536
BRACKET.....	59 01 (WST)(WAT).....	1	313 6640
	59 01 (WOD).....	1	313 0969
KNOB.....	59 10-20-80.....	1	342 2227
CLAMP.....	59 01-10-20-80.....	1	313 0267
GROMMET (In Dash).....	59 10-20-80.....	1	438 8864
SCREW, Clamp.....	59 01.....	1	G172111
	59 10-20-80.....	1	G443824
Control.....	59 10-20-80.....	2	G187303
(To Pivot).....	59 01.....	1	800 0086
Knob.....	59 10-20-80.....	1	G134168
Bracket.....	59 01.....	2	G445615
WASHER (Lock).....	59 01.....	1	G114606
Bracket.....	59 01.....	2	G120214

AMERICAN MOTORS PARTS CATALOG

NUT.....	59 01.....	1	G124925
Bracket.....	59 01.....	2	G120368
(Speed), Cable To Control.....	59 10-20-80.....	1	314 6630
22.023 DAMPER, Cowl Ventilator			
DAMPER.....	59 01.....	1	313 6531
	59 10-20-80.....	1	315 2158
FLAP (11-34" Length).....	59 10-20-80.....	1	342 3513
FILTER (In Air Chamber)(Less Heater).....	59 10-20-80.....	1	342 3542
CLIP, Filter (Less Heater).....	59 10-20-80.....	4	310 8634
SCREW.....	59 01.....	2	G174964
	59 10-20-80.....	2	G125591
WASHER (Lock).....	59 01.....	2	G131096
22.027 MOTOR, Windshield Wiper			
MOTOR.....	59 01.....	1	343 1790
	59 10-20-80.....	1	343 8513
BRACKET.....	59 01.....	1	437 7453
SCREW, To Bracket.....	59 01.....	2	G447121
	59 10-20-80.....	2	342 9760
22.030 RETAINER, Windshield Wiper Linkage			
RETAINER.....	59 01-10-20-80.....	1	436 8314
22.038 CONTROL, Windshield Wiper			
CONTROL.....	59 01.....	1	343 1803
	59 10-20-80 (LHD).....	1	343 8522
	59 10-20-80 (RHD).....	1	343 8523
SPACER.....	59 10-20-80.....	1	342 1850
GROMMET.....	59 10-20-80.....	1	436 5163
22.039 KNOB, Windshield Wiper Control			
KNOB.....	59 01.....	1	343 0573
(Black).....	59 10-20-80.....	1	341 6973
(Chrome).....	59 80.....	1	342 2237
22.041 NUT, Windshield Wiper Control Holding			
NUT.....	59 01-10-20-80.....	1	343 9368
22.043 BLADE, Windshield Wiper			
BLADE.....	59 01.....	2	343 1797
	59 10-20-80.....	2	343 8521
22.044 ARM, Windshield Wiper			
ARM (Left).....	59 01.....	1	343 1795
	59 10-20-80.....	1	343 8519
(Right).....	59 01.....	1	343 1796
	59 10-20-80.....	1	343 8520

AMERICAN MOTORS PARTS CATALOG

22.056

22.047 BODY, Windshield Wiper Pivot Shaft

BODY (Left).....	59 01.....	1	343 1793
	59 10-20-80.....	1	343 8517
(Right).....	59 01.....	1	343 1794
	59 10-20-80.....	1	343 8518
SPACER, Outer.....	59 01-10-20-80.....	2	343 8514
NUT, Body Retaining (Outer).....	59 01-10-20-80.....	2	343 8498
(Inner).....	59 01-10-20-80.....	2	341 0262
GROMMET, Body Link To Motor (Rubber).....	59 01-10-20-80.....	2	343 8524

22.050 TUBE-HOSE, Windshield Wiper

TUBE, Cylinder Head To Booster.....	59 01.....	1	315 5497
(At Head).....	59 10.....	1	315 6568
(At Booster)....	59 10.....	1	315 6569
Manifold To Booster.....	59 20-80.....	1	315 6572
Booster To Wiper Motor Hose.....	59 01.....	1	315 5516
	59 10.....	1	315 6571
	59 20-80.....	1	315 6573
HOSE, Cylinder Head To Booster Tubes.....	59 10.....	1	315 6570
To Wiper Motor.....	59 01.....	1	437 3381
	59 10-20-80 (Less Heater).....	1	315 6576
	59 10-20-80 (With Heater).....	2	343 7624
Bulk (7/32 I.D. x 13/32 O.D.)(Order In Feet)....	59 01.....	AR	320 2249
Feet)....	59 10-20-80.....	AR	320 2250
(9/32 I.D. x 13/32 O.D.)(Order In			
TEE, Cylinder Head To Booster Tube.....	59 01 (WAT).....	1	G143482
ELBOW, Cylinder Head To Booster Tube.....	59 01 (WST)(WOD).....	1	G137422
Manifold Vacuum Outlet.....	59 20-80.....	1	G137422
Booster Inlet.....	59 20-80.....	1	G137422
NUT, To Booster Inlet.....	59 10.....	1	G137398
Outlet.....	59 01.....	1	G137397
	59 10-20-80.....	1	G137398
CLIP, Fuel And Vacuum Tubes.....	59 20-80.....	1	315 6574

22.056 PANEL, Instrument

PANEL.....	59 01.....	1	342 5841
	59 10-20 (LHD).....	1	343 5502
	59 10-20 (RHD).....	1	343 5504
	59 80 (LHD).....	1	343 5503
	59 80 (RHD).....	1	343 5504
BRACE, Instrument Panel To Dash.....	59 01.....	1	437 7802
	59 10-20-80 (W/O Heater).....	1	343 0078
(Hand Brake Support)....	59 01.....	1	342 4528
To Distribution Duct...	59 10-20-80 (W/Heater).....	1	343 0175
SCREW, Panel To Dash Panel.....	59 10-20-80.....	8	G161869
To Front Body Pillar.....	59 10-20-80.....	2	G161869
Brace To Dash Panel.....	59 01.....	2	G180018
	59 10-20-80 (W/O Heater).....	1	G161895
(Hand Brake Support)	59 01.....	1	G189129
To Distribution Duct.....	59 10-20-80 (W/Heater).....	1	G161895
To Instrument Panel.....	59 01.....	1	G189129
STUD, Panel To Front Body Pillar.....	59 10-20-80.....	2	341 6690
WASHER, Brace To Dash Panel.....	59 01-10-20-80.....	1	G120214
To Instrument Panel.....	59 01-10-20-80.....	1	G120392

AMERICAN MOTORS PARTS CATALOG

Panel To Front Body Pillar.....	59 10-20-80.....	2	G120392
NUT, Brace To Panel.....	59 01-10-20-80.....	1	G271172
Panel To Front Body Pillar.....	59 01-10-20-80.....	2	G120375

22.058 BOX, Glove

BOX.....	59 01 (LAC).....	1	447 5663
	59 01 (WAC).....	1	343 1955
	59 10-20-80.....	1	342 7585
LINING.....	59 01.....	1	343 9279
PANEL, Mounting.....	59 01.....	1	437 3235
HANDLE.....	59 01.....	1	437 3000
SCREW, Box To Instrument Panel.....	59 10-20-80.....	4	G161860
Panel To Instrument Panel.....	59 01.....	8	G161895
Handle To Box.....	59 01.....	2	800 0045

22.060 DOOR, Glove Box

DOOR.....	59 10-20-80.....	1	342 2172
HINGE.....	59 10-20-80.....	1	342 2215
SCREW, To Door.....	59 10-20-80.....	3	G444272
To Instrument Panel.....	59 10-20-80.....	3	800 0107

22.066 LINK, Glove Box Door Check

LINK.....	59 10-20-80.....	1	342 2225
SILENCER.....	59 10-20-80.....	1	342 1742
SCREW, To Door.....	59 10-20-80.....	2	G444272

22.072 BUMPER, Glove Box Door

BUMPER.....	59 01.....	2	435 0919
	59 10-20-80.....	2	342 2140

22.073 LOCK, Glove Box (Ref. Note 22.073-1)

LOCK (Incl. Keys)(Regular).....	59 01.....	1	447 5936
	59 10-20-80.....	1	447 8236
(Special)(Specify Key No.)....	59 01.....	1	447 5937
	59 10-20-80.....	1	447 8237
CYLINDER (Incl. Keys)(Regular).....	59 01-10-20-80.....	1	447 5938
(Special)(Specify Key No.).....	59 01-10-20-80.....	1	447 5939
CASE (Incl. Bolt).....	59 01-10-20-80.....	1	447 5616
RETAINER.....	59 01.....	1	437 3298
SCREW, Retainer.....	59 01.....	1	G271075
KEY (Blank).....	59 01-10-20-80.....	2	438 5552
(Coded)(Specify Key No.).....	59 01-10-20-80.....	2	447 5925

22.075 STRIKER, Glove Box Lock

STRIKER.....	59 01.....	1	435 4407
	59 10-20-80.....	1	342 1820
SCREW, To Panel.....	59 10-20-80.....	2	G161860

NOTE 22.073: Regular indicates Cylinder is not set to any specified Key No.
 Special indicates Cylinder is set to a specified Key No.

AMERICAN MOTORS PARTS CATALOG

22.100

22.077 GRILLE, Radio Speaker

GRILLE (Left)(Blue).....	59 10-20-80 (LAC).....	1 343 1551
(Green).....	59 10-20-80 (LAC).....	1 343 1553
(Black).....	59 10-20-80 (LAC).....	1 342 5709
(Copper).....	59 10-20-80 (LAC).....	1 343 9491
(Right)(Blue).....	59 10-20-80 (LAC).....	1 343 1552
(Green).....	59 10-20-80 (LAC).....	1 343 1554
(Black).....	59 10-20-80 (LAC).....	1 342 5710
(Copper).....	59 10-20-80 (LAC).....	1 343 9492
SCREW (Use W/O Pad).....	59 10-20-80 (LAC).....	8 800 0272
(Use With Pad).....	59 10-20-80 (LAC).....	8 G161869

22.092 TRAY, Instrument Panel Ash Receiver

TRAY.....	59 01.....	1 311 4706
	59 10-20-80.....	2 342 2258
BUMPER.....	59 10-20-80.....	2 435 0919

22.093 COVER, Instrument Panel Ash Receiver

COVER.....	59 01.....	1 312 8552
	59 10-20-80.....	2 342 2176
NUT.....	59 10-20-80.....	2 342 2038

22.096 RETAINER, Instrument Panel Ash Receiver

RETAINER.....	59 10-20-80.....	2 342 2168
BRACKET.....	59 10-20-80.....	2 342 2199
SCREW, Retainer To Instrument Panel.....	59 10-20-80.....	4 800 0272
To Bracket.....	59 10-20-80.....	2 800 0272
Bracket To Instrument Panel.....	59 10-20-80.....	2 800 0272

22.098 PANEL, Ash Receiver And Instrument Switch Mounting

PANEL.....	59 01.....	1 342 5842
WASHER (Lock).....	59 01.....	2 G103319
(Fibre).....	59 01.....	2 436 8016
NUT.....	59 01.....	2 G120367

22.100 PAD - OVERLAY - PANEL - MOULDING, Instrument Panel

PAD, Instrument Panel

PAD (Black).....	59 10-20-80.....	1 343 5551
(Blue).....	59 10-20-80.....	1 343 5552
(Green).....	59 10-20-80.....	1 343 5553
(Copper).....	59 10-20-80.....	1 343 9442

OVERLAY, Instrument Panel

OVERLAY, Center Finish.....	59 10-20-80.....	1 342 2179
Instrument Control Identification		
(White Lettering).....	59 10-20 (LHD).....	1 343 5555
Instrument Control Identification		
(White Lettering).....	59 10-20 (RHD).....	1 343 5556

NOTE 22.100-1: Use on Fleet Cars W/O Radio

AMERICAN MOTORS PARTS CATALOG

Instrument Control Identification (White Lettering).....	59 80 (LHD).....	1	343 5621
Instrument Control Identification (White Lettering).....	59 80 (RHD).....	1	343 5622
Instrument Control Identification (Orange Lettering).....	59 10-20 (LHD).....	1	343 5557
Instrument Control Identification (Orange Lettering).....	59 10-20 (RHD).....	1	343 5558
Instrument Control Identification (Orange Lettering).....	59 80 (LHD).....	1	343 5623
Instrument Control Identification (Orange Lettering).....	59 80 (RHD).....	1	343 5624
SCREW, Center Finish Overlay.....	59 10-20-80.....	9	800 0058
Identification Overlay.....	59 10-20-80.....	2	G162289
FERRULE, Identification Overlay.....	59 10-20-80.....	2	342 1958
 PANEL, Instrument Panel			
PANEL.....	59 01 (With Clock).....	1	342 5847
	59 01 (With Clock)(Note 22.100-1).....	1	343 0591
	59 01 (W/O Clock).....	1	342 5846
	59 01 (W/O Clock)(Note 22.100-1).....	1	343 0590
 MOULDING, Instrument Panel			
MOULDING.....	59 01.....	1	437 3284
End (Left).....	59 10-20-80 (LHD).....	1	342 2177
	59 10-20-80 (RHD).....	1	342 2170
(Right).....	59 10-20-80 (LHD).....	1	342 2178
	59 10-20-80 (RHD).....	1	342 2171
SCREW, End Moulding.....	59 10-20-80.....	4	800 0058
 22.103 PLATE, Instrument Panel Name			
PLATE "American".....	59 01.....	1	342 5784
"Rambler".....	59 10-20.....	1	314 0694
"Ambassador".....	59 80.....	1	314 0690
CLIP.....	59 01-10-20-80.....	3	437 7405
 22.120 COVER, Windshield Wiper Motor Access Hole			
COVER.....	59 10-20-80.....	1	341 1139
GASKET.....	59 10-20-80.....	1	341 1141
SCREW.....	59 10-20-80.....	4	G186469